

# PASTRY GREEN

Euronorm 60x40 e 60x80

## Armadi Refrigerati

- costruzione interamente in acciaio inox AISI 304
- interno con spigoli arrotondati e fondo stampato
- isolamento di 60 mm in poliuretano ecologico
- allestimento interno per teglie Euronorm 60x40 / 60x80
- cremagliere (passo 24 mm) e guide in acciaio inox AISI 304
- refrigerazione ventilata con evaporatore trattato con vernici anticorrosione
- gruppo frigorifero a tampone facilmente sostituibile
- gas refrigerante R290 (propano)
- pannello comandi elettronico Energy Saving con funzione HACCP
- gestione allarmi di temperatura e allarme condensatore sporco
- funzione di raffreddamento rapido "Overcooling"
- possibilità di impostazione alta e bassa umidità
- sbrinamento automatico con resistenza
- porta seriale per collegamento a sistemi di supervisione
- modelli a porta cieca con unità condensatrice in classe SN-T (max +43°C)
- modelli a porta vetrata con unità condensatrice in classe N (max +32°C)
- evaporazione automatica della condensa con resistenza autoregolante
- illuminazione interna
- chiusura con chiavi
- porte autochiudenti con fermo a 105°
- guarnizioni magnetiche facilmente sostituibili
- piedini in acciaio inox regolabili in altezza (130-200 mm)

### Dotazioni standard:

nr 20 coppie di guide ad "L" in acciaio inox

### Imballo su pallet e con cartone incluso

## Refrigerated Cabinets

- construction completely in stainless steel AISI 304
- inside with rounded corners and moulded bottom
- 60 mm insulation by environment-friendly polyurethane
- internal fitting for Euronorm 60x40 / 60x80 trays
- racks (24 mm pitch) and slideways in stainless steel AISI 304
- air-cooled refrigeration with evaporators with anticorrosive treatment
- easily replaceable plug-in refrigerating unit
- R290 (propane) refrigerant gas
- Energy Saving electronic control panel with HACCP function
- temperature and dirty condenser alarm management
- "Overcooling" quick cooling function
- possibility of setting high/low humidity
- automatic defrosting with heater cable
- serial port for connection to supervision systems
- solid-door models with SN-T class condensing unit (max +43°C)
- glass-door models with N class condensing unit (max +32°C)
- automatic evaporation of condensate water with self-adjusting heater cable
- internal light
- key-lock
- self-closing door with stop at 105°
- easily replaceable magnetic gaskets
- adjustable in height (130-200 mm) stainless steel feet

### Standard equipment:

nr 20 pairs of stainless steel "L" slideways

### Package on pallet with cardboard included

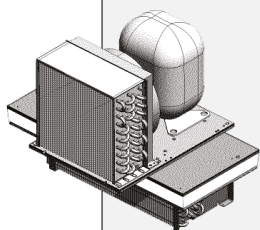
**GAS R290  
PROPANO**

**Unità refrigerante "MONOBLOCCO" con evaporatore in cella.  
Facilmente estraibile per sostituzione e/o manutenzione**

"MONOBLOCK" refrigerating unit with internal evaporator.  
Easily extractable for replacement a/o maintenance.



Mod. PASTRY 70



Mod. PASTRY 100



**Pannello comandi**  
Control panel

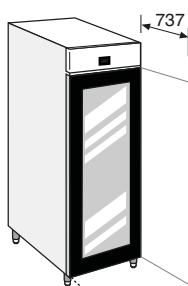
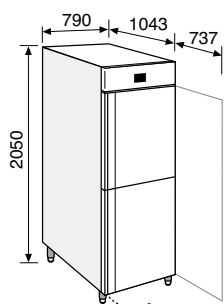
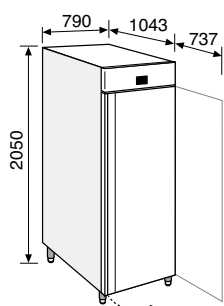
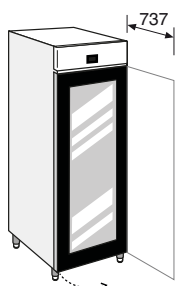
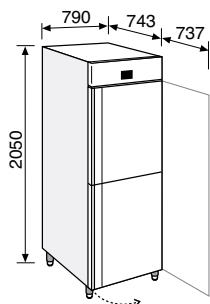
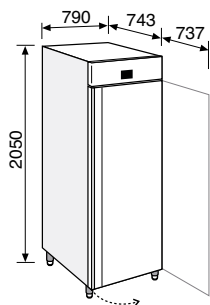

Codice Code	Modello Model	Temperatura Temperature °C	Capacità Capacity Lt	Peso N / L N / G weight Kg	Prezzo Price €
----------------	------------------	----------------------------------	----------------------------	----------------------------------	----------------------

### PASTRY GREEN 70

L 790 x P 743 x H 2050 mm  
L 830 x P 790 x H 2206 mm (Con imballo / Packed)

ADK021	<b>PASTRY GREEN 71 TNBV</b>	-2° +10°C	573	150 / 165	<b>3.470</b>
Tensione / Voltage				230V - 50 Hz	
Potenza frig./ Refrig.power - Evap. -10°C / Cond. 54,4°C				498 W	
Potenza assorbita / Absorbed power				350 W / 2,5 A	
Gas				R290	

### PASTRY GREEN 72

L 790 x P 743 x H 2050 mm  
L 830 x P 790 x H 2206 mm (Con imballo / Packed)

ADK022	<b>PASTRY GREEN 72 TNBV</b>	-2° +10°C	573	150 / 165	<b>4.040</b>
Tensione / Voltage				230V - 50 Hz	
Potenza frig./ Refrig.power - Evap. -10°C / Cond. 54,4°C				498 W	
Potenza assorbita / Absorbed power				350 W / 2,5 A	
Gas				R290	

### PASTRY GREEN GLASS 70

L 790 x P 743 x H 2050 mm  
L 830 x P 790 x H 2206 mm (Con imballo / Packed)

ADK221	<b>PASTRY GREEN G 71 TNV</b>	0° +10°C	573	160 / 175	<b>3.910</b>
Tensione / Voltage				230V - 50 Hz	
Potenza frig./ Refrig.power - Evap. -10°C / Cond. 54,4°C				498 W	
Potenza assorbita / Absorbed power				350 W / 2,5 A	
Gas				R290	

### PASTRY GREEN 100

L 790 x P 1043 x H 2050 mm  
L 830 x P 1090 x H 2206 mm (Con imballo / Packed)

ADK031	<b>PASTRY GREEN 101 TNBV</b>	-2° +10°C	875	164 / 179	<b>3.920</b>
Tensione / Voltage				230V - 50 Hz	
Potenza frig./ Refrig.power - Evap. -10°C / Cond. 54,4°C				762 W	
Potenza assorbita / Absorbed power				550 W / 3,7 A	
Gas				R290	

### PASTRY GREEN 102

L 790 x P 1043 x H 2050 mm  
L 830 x P 1090 x H 2206 mm (Con imballo / Packed)

ADK032	<b>PASTRY GREEN 102 TNBV</b>	-2° +10°C	875	164 / 179	<b>4.540</b>
Tensione / Voltage				230V - 50 Hz	
Potenza frig./ Refrig.power - Evap. -10°C / Cond. 54,4°C				762 W	
Potenza assorbita / Absorbed power				550 W / 3,7 A	
Gas				R290	

### PASTRY GREEN GLASS 100

L 790 x P 1043 x H 2050 mm  
L 830 x P 1090 x H 2206 mm (Con imballo / Packed)

ADK231	<b>PASTRY GREEN G 101 TNV</b>	0° +10°C	875	174 / 189	<b>4.410</b>
Tensione / Voltage				230V - 50 Hz	
Potenza frig./ Refrig.power - Evap. -10°C / Cond. 54,4°C				762 W	
Potenza assorbita / Absorbed power				550 W / 3,7 A	
Gas				R290	